

# P5627

## Limit switch device

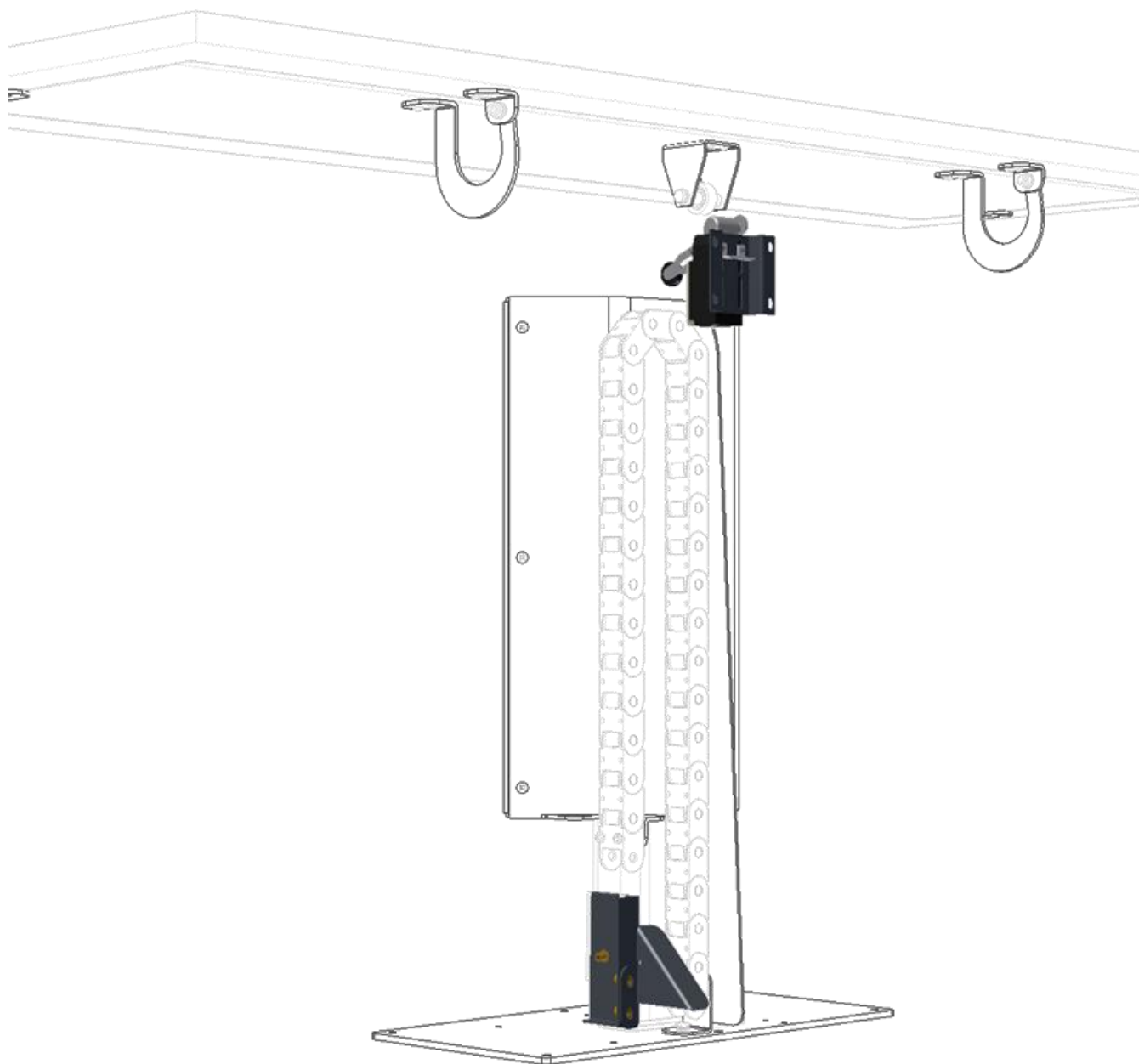

**1.**  
When the lift is installed in the cabinet, install the switch to the back of the cabinet back wall or underneath the top plate.  
Shown as below the switch in in line with the panel hinge.

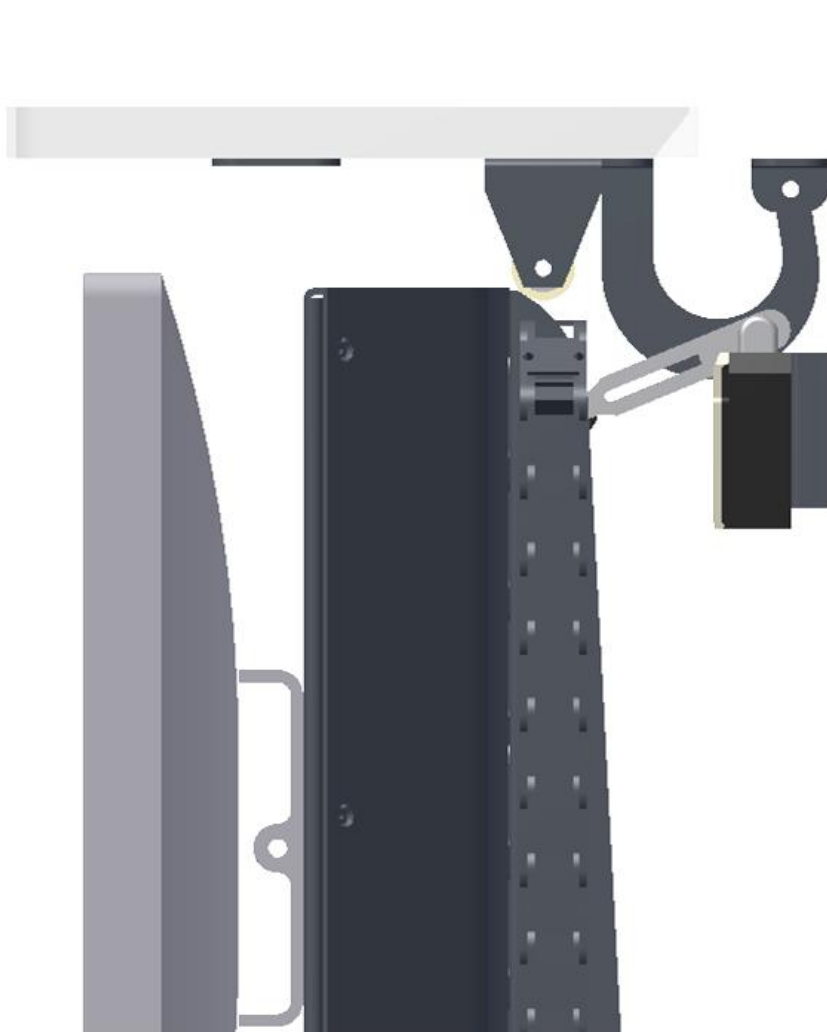
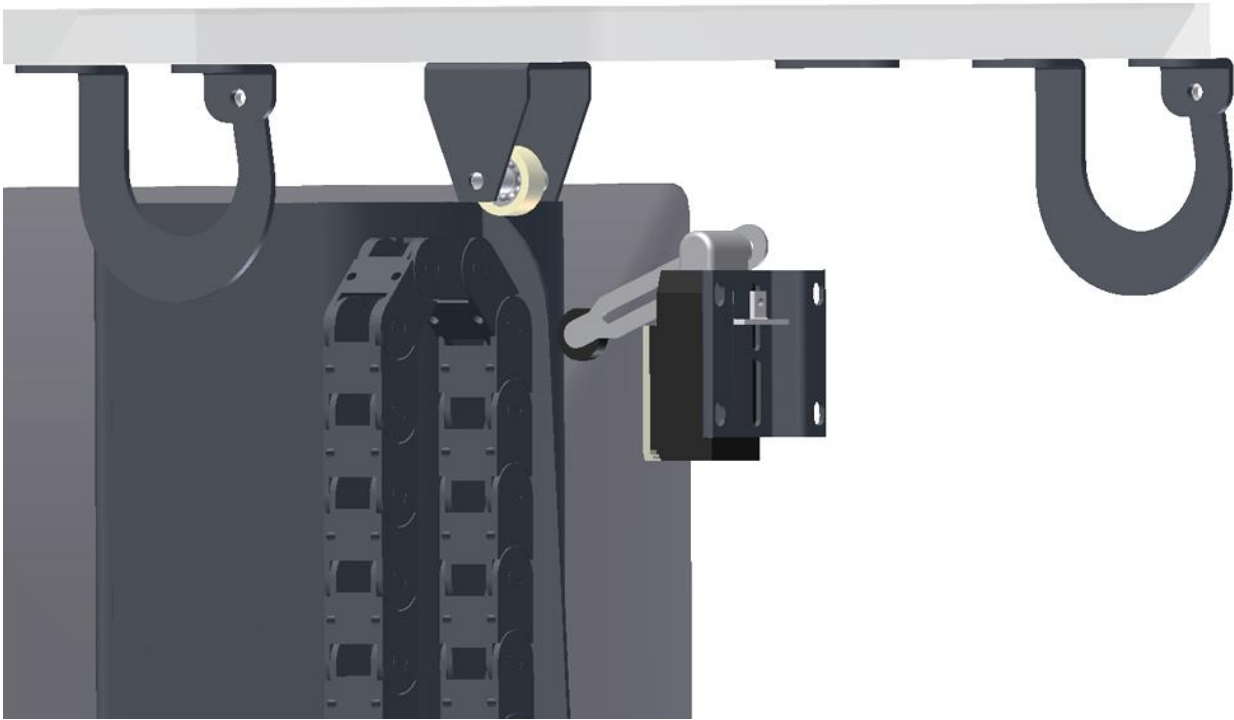

**2. The switch can be fine adjusted with the slot mounting plate. Simple undo the screws a bit to adjust the switch.**

**Install the triangle part to the ribbon on the lift.**

**Except for the lift system *P3674*.**

**The triangle will be mounted with an extra part (631995) to the column.**

**Line out all parts and check functionality carefully.**

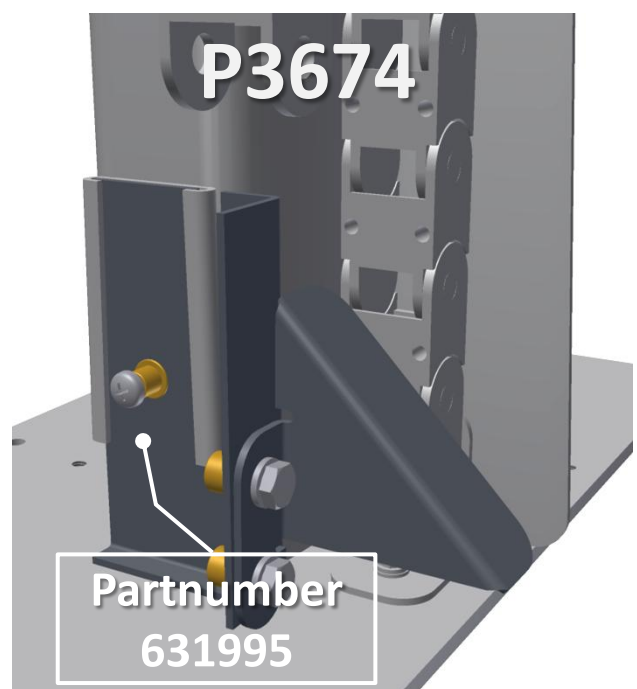
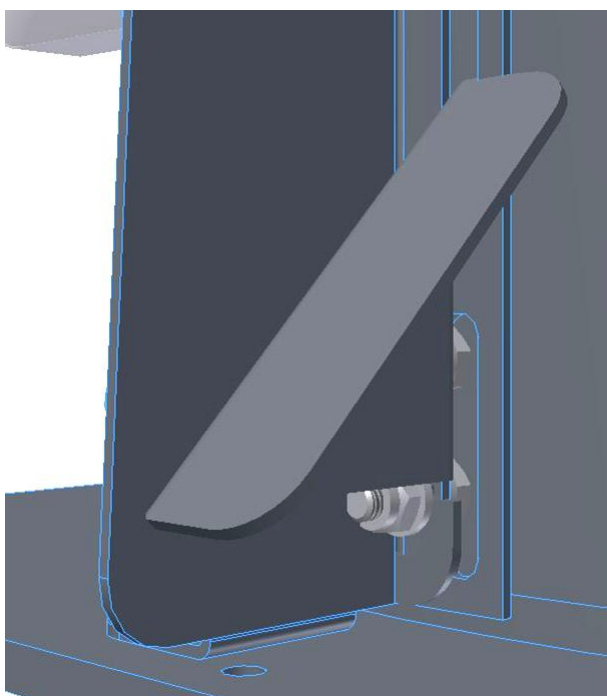
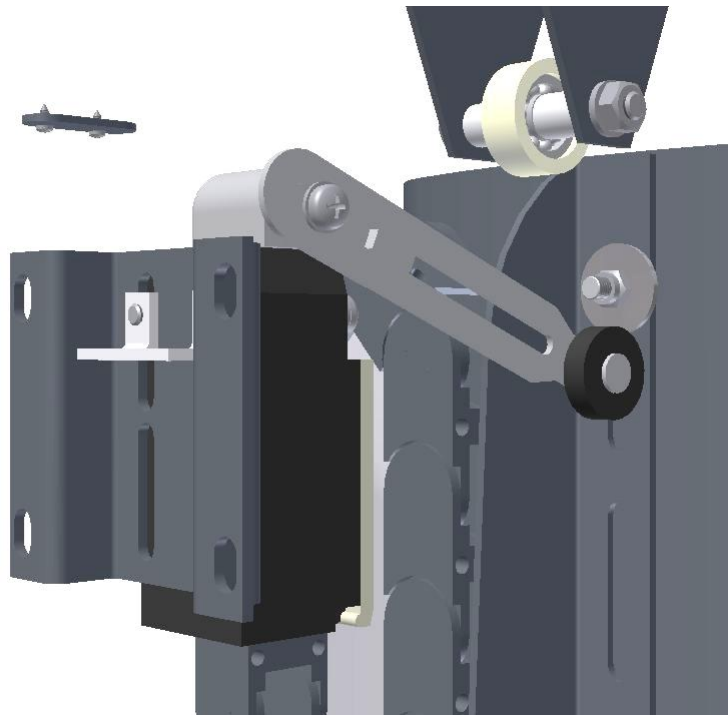

For connecting or activating the system the standard applied table switch can be used.



When the system must be connected or activated with an external control system, use the below listed option:

- use a separate potential free relay or switch with neutral middle position for each direction
- always use potential free contact closures (dry contacts)
- switching time delay of at least 0.5 seconds for up and down direction.

For use with an external control system the standard cable can be modified by cutting of the switch and use below listed / attached colour scheme to activate the system.

Second option is to use a new control cable with an RJ45 connector.

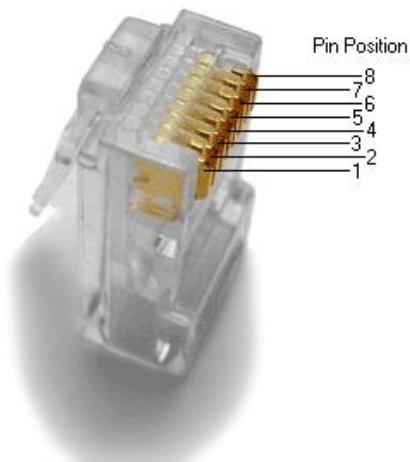

**Pos. 8 red (down)**  
**Pos. 5 green (up)**  
**Pos. 4 blue (common)**

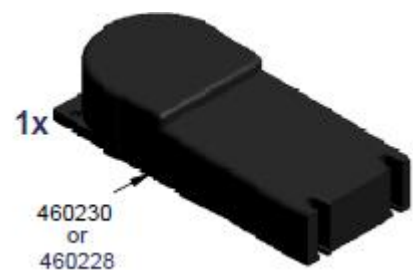

### 3. Limit switch for the UP direction

How to route the green wire of the table switch thru the limit switch.

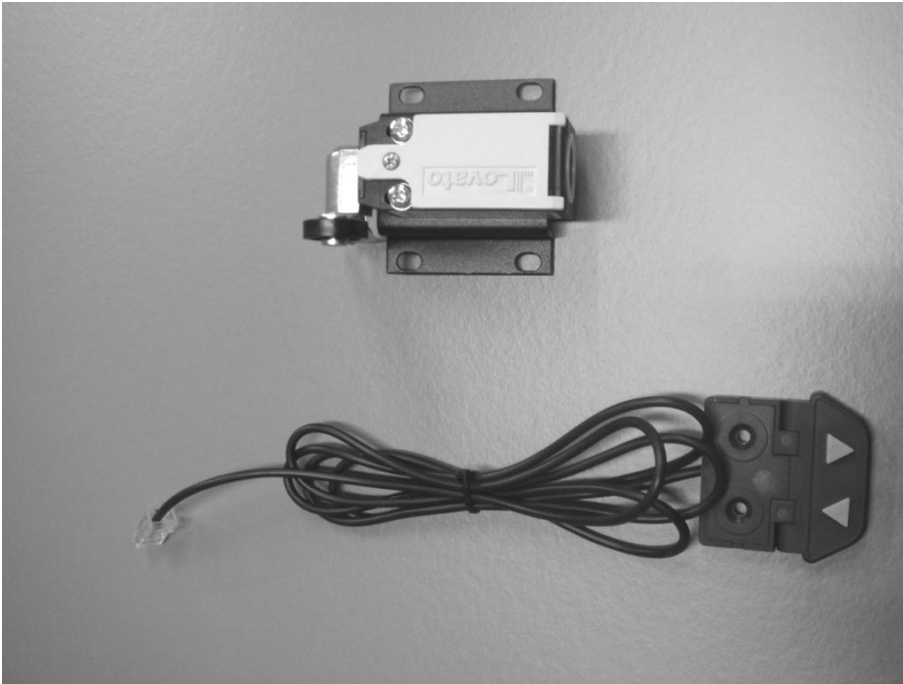

#### STEP 1

Take the limit and table switch

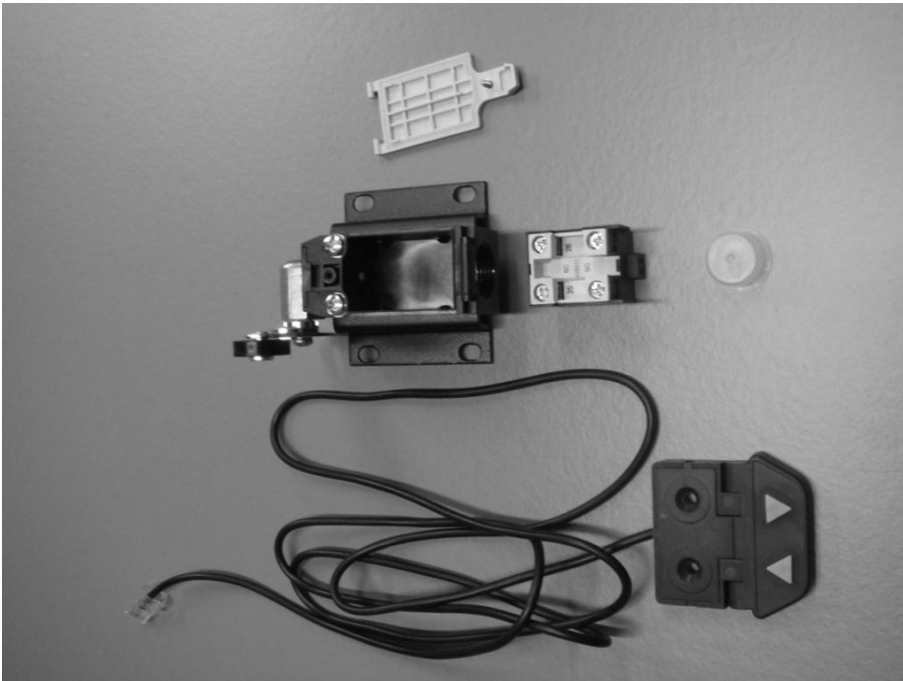

#### STEP 2

Take the cover off and the contacts out of the limit switch

# Positioning of the limit switch head

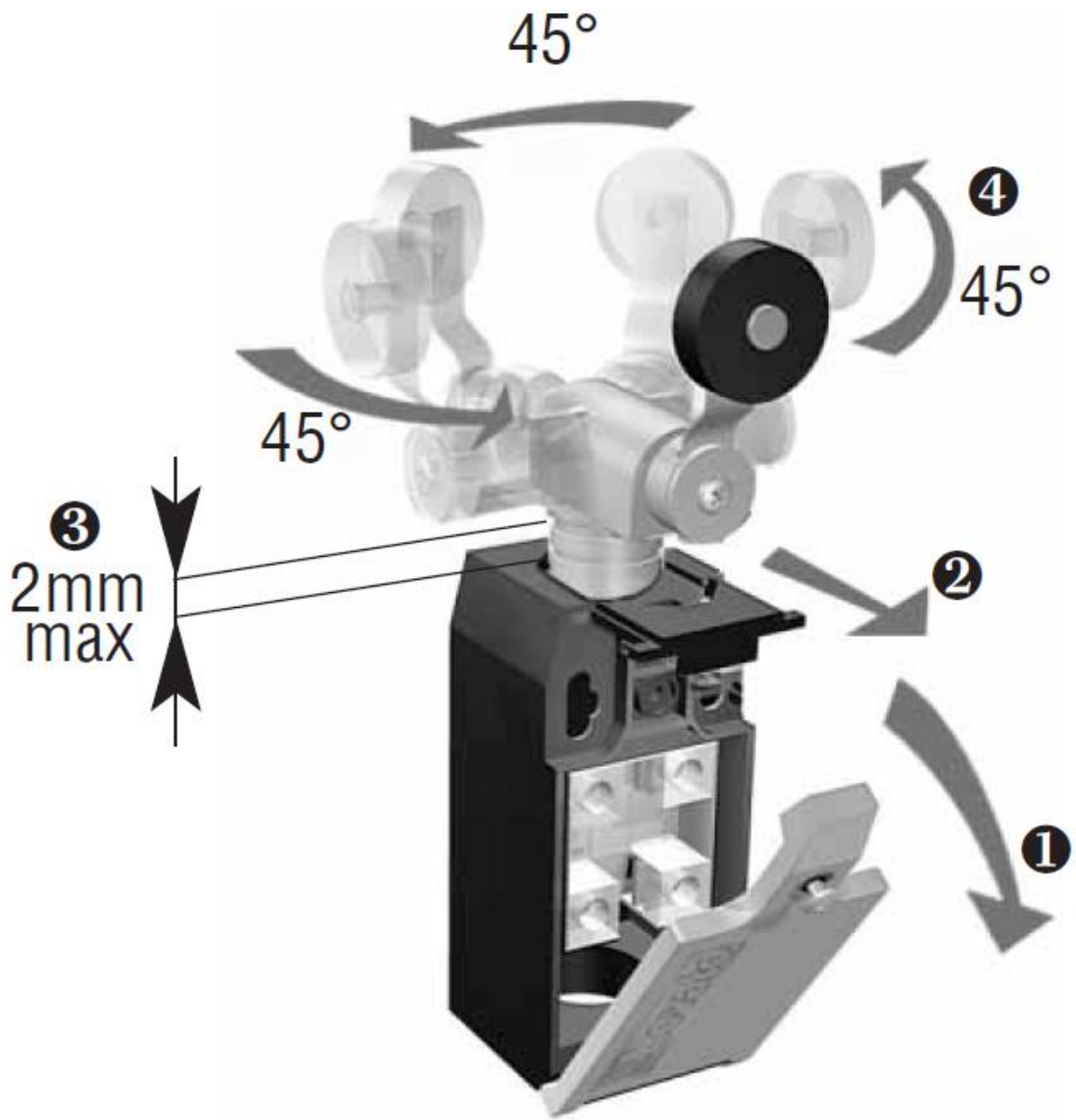

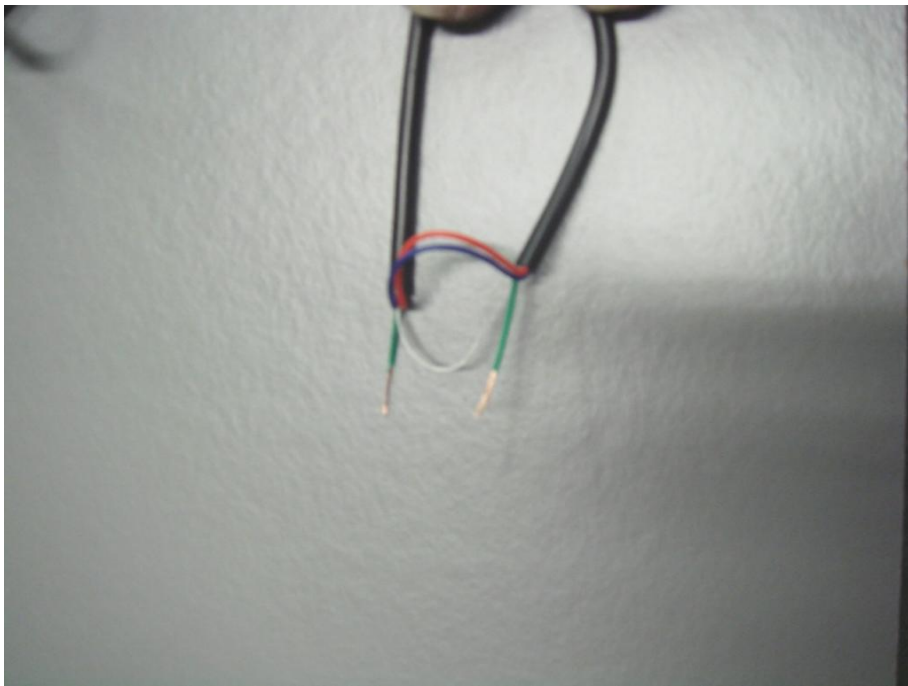

### STEP 3

Cut the cable shell and remove it over about 60 mm.

Cut the green wire in between.

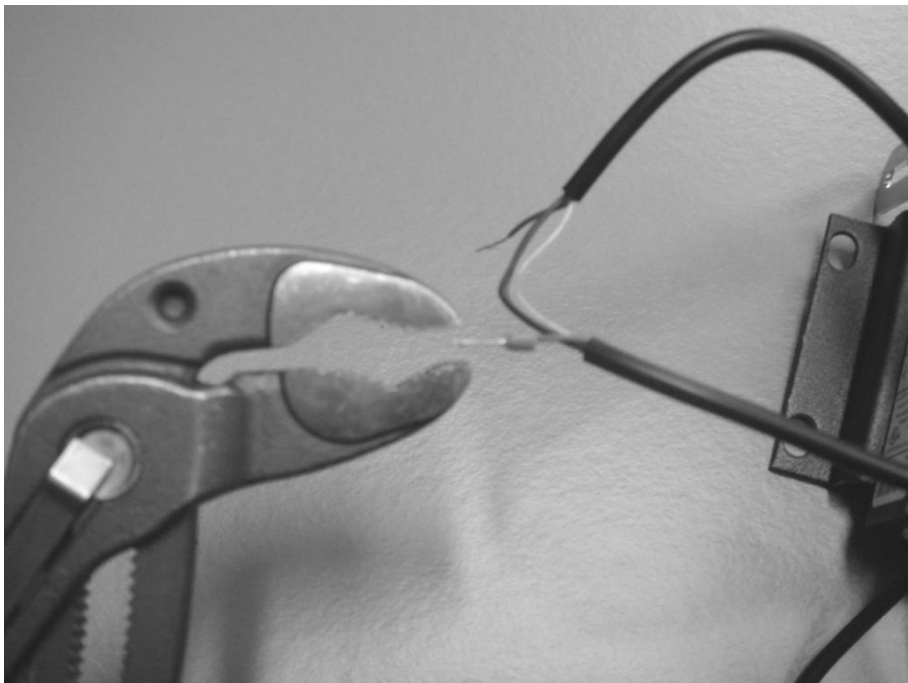

### STEP 4

Shrink the ferrules on the wire ends.



### STEP 5

Screw one end of the green wire on connection (25), the other end on connection (26)

Put the cover on the limit switch.

**Single and double column connecting scheme.  
FOR the single column version connect the motor to port 1.**

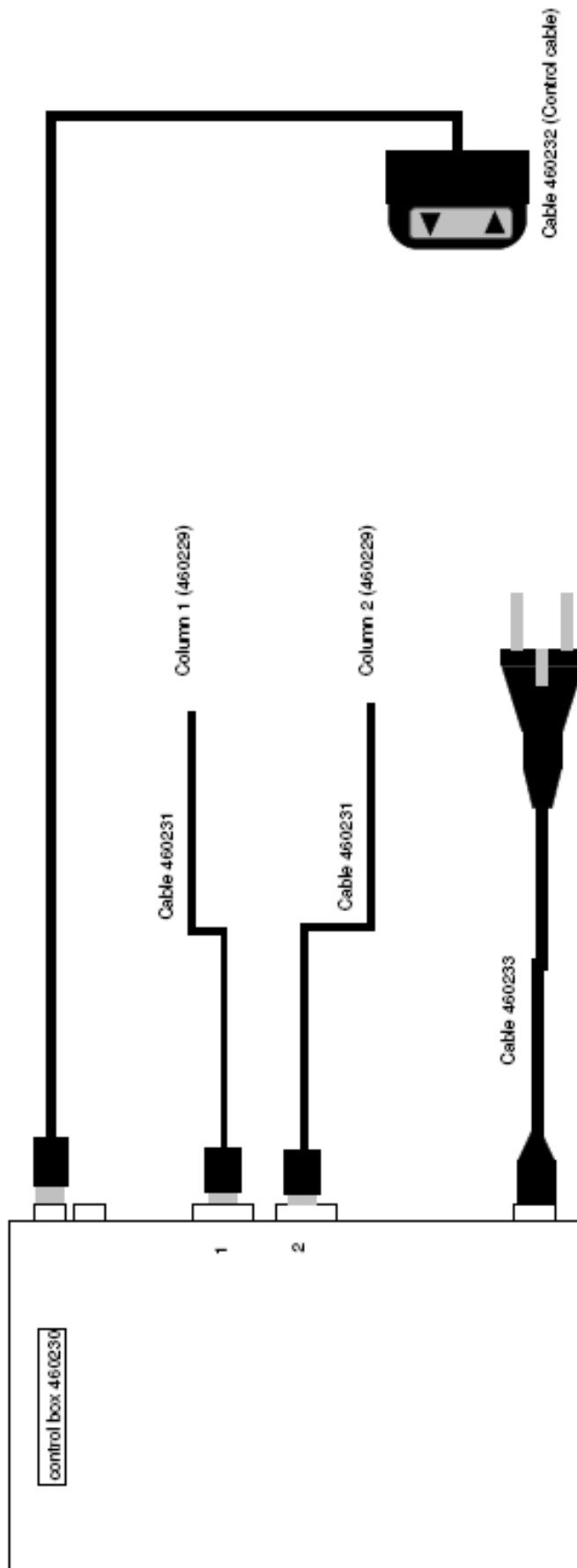



**Audipack's general conditions of sales and delivery apply to all of Audipack's deliveries. These conditions can be downloaded from Audipack's website, [www.audipack.com](http://www.audipack.com), or will be sent by post on request.**

**Audipack liefert ausschließlich unter die allgemeine Verkauf- und Lieferungsbedingungen von Audipack. Diese Bedingungen sind zum downloaden verfügbar auf die Webseite von Audipack, [www.audipack.com](http://www.audipack.com), oder werden Ihnen auf Anfrage per Post gesendet.**

**Alle leveringen geschieden uitsluitend volgens de Algemene Verkoop- en Leveringsvoorwaarden van Audipack. Een afschrift hiervan kunt u downloaden van de website van Audipack, [www.audipack.com](http://www.audipack.com), of wordt u op aanvraag gestuurd per post.**

**Les conditions de vente et de livraison de Audipack s'appliquent à tous les livraisons de Audipack. Cette conditions sont disponible sur le site internet de Audipack, [www.audipack.com](http://www.audipack.com), où seront envoyé par poste sur demande.**

**AUDIPACK**

Industriestraat 2-4  
2751 GT Moerkapelle  
the Netherlands

Tel: +31(0)795931671  
Fax: +31(0)795933115  
Email: [audipack@audipack.com](mailto:audipack@audipack.com)

[www.audipack.com](http://www.audipack.com)

Audipack reserves the right to make changes in specifications and other information contained in this document without prior written notice. The information provided herein is subject to change without notice. In no event shall Audipack be liable for any incidental, special, indirect, or consequential damages whatsoever, including but not limited to lost profits, arising out of or related to this manual or the information contained herein, even if Audipack has been advised of, known, or should have known, the possibility of such damages.